

GE170-20SP

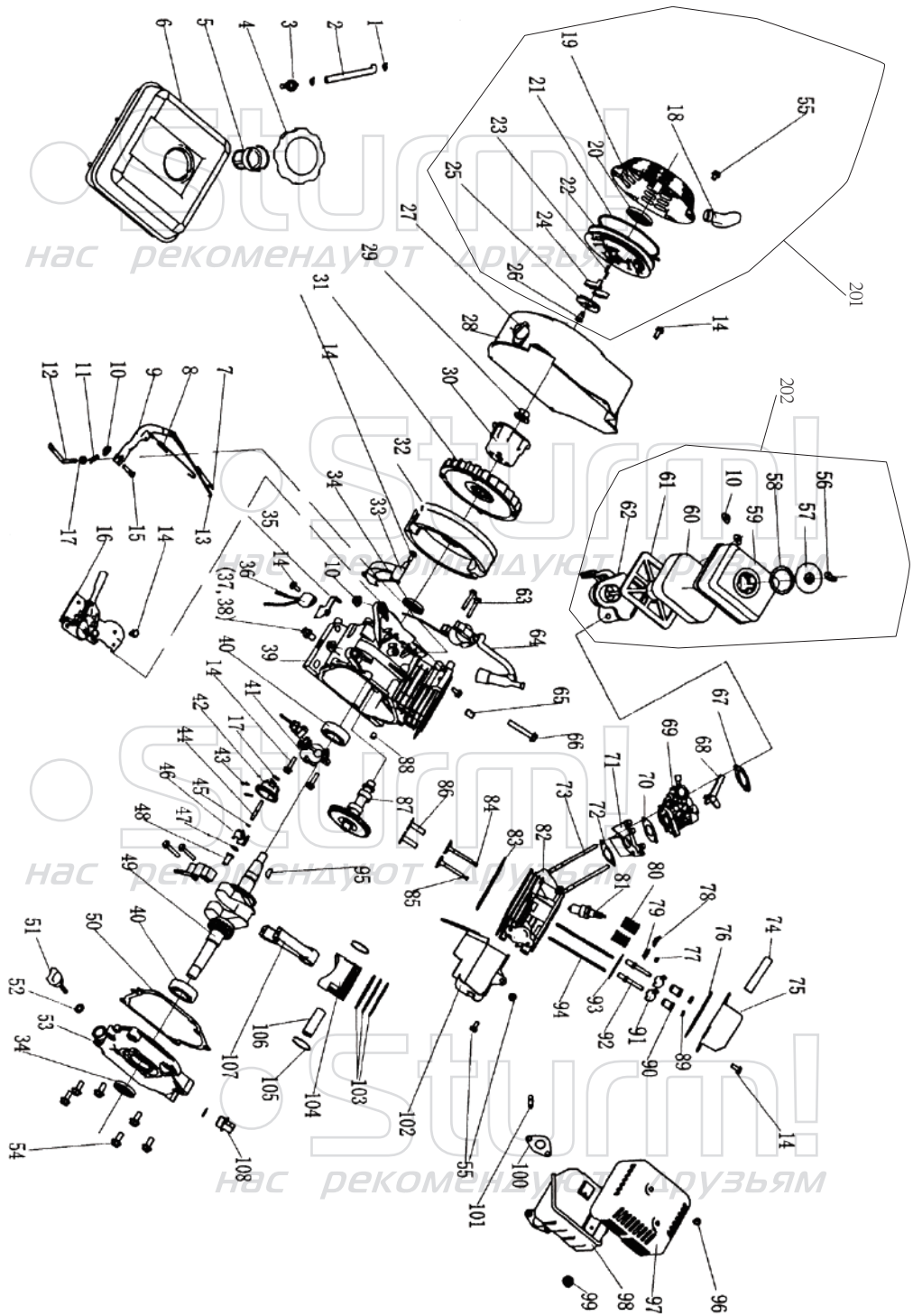

NO.	DESCRIPTION	NO.	DESCRIPTION
1	CLIP TUBE	56	NUT TOOL BOX SETTING
2	TUBE FUEL	57	COVER AIR CLEANER
3	JOINT ASSY FUEL TANK	58	SEAL AIR CLEANER
4	CAP COMP FUEL FILLER	59	COVER AIR CLEANER
5	FILTER FUEL	60	FILTER OUTER
6	TANK COMP FUEL	61	NOSE SILENCER
7	SPRING THROTTLE RETURN	62	ELBOW COMP AIR CLEANER
8	SPRING THROTTLE RETURN	63	BOLT FLANGE 6*25
9	ARM GOVERNOR	64	COIL ASSY IGNITION
10	NUT FLANGE	65	PIN DOWER
11	PIN LOCK	66	BOLT FLANGE 8*55
12	SHAFT GOVERNOR ARM	67	SPACER COMP AIR CLEANER
13	ROD GOVERNOR	68	LEVER COMP CHOKE
14	BOLT FLANGE	69	CARBURETOR
15	BOLT QUADRATE HEAD	70	PACKING CABURETOR
16	CONTROL ASSY	71	INSULATOR CARBURETOR
17	WASHER PAIN	72	PACKING INSUL ATOR
18	KNOB RECOIL STARTER	73	BOLT STUD IN
19	COVER COMP FAN	74	TUBE BREATHER
20	SPRING RECOIL SATRTER	75	COVER COMP HEAD
21	REEL RECOIL STARTER	76	PACKING HEAD COVER
22	ROPE	77	RATATOR VALVE
23	SPRING RETURN	78	SEAL GUIDE
24	RATCHET STARTER	79	RETAINER VALVE SPRING
25	GUIDE RATCHET	80	SPRING VALVE
26	SCREW SETTING	81	PLUG SPARK
27	SWITCH ASSY ENGINE STOP(OIL ALERT)	82	HEAD COMP CYLINDER
28	COVER COMP FAN	83	GASKET CYLINDER
29	NUT SPECIAL	84	VALVE IN
30	PULLEY STARTER	85	VALVE EX
31	FAN COOLING	86	LEFTER VALVE
32	FLYWHEEL COMP	87	CAMSHAFT ASSY
33	DIVERSION ASSY	88	PIN FLYING BLOCK
34	OIL SEAL25*41.25*6	89	NUT PIVOT ADJUSTING
35	PLATE SIDE SUPPORT	90	PIVOT ROCKER ARM
36	ALART UNIT OIL	91	ARM VALVE ROCKER
37	BOLT DRAIN PLUG	92	BOLT PIVOT ARM
38	WASHER DRAIN PLUG 10x15x1.2	93	PLATE ASSY
39	CRANK CASE	94	ROD PUSH
40	BEARING RADIAL BALL	95	KEY SPECIAL WOODRUFF
41	OIL LEVEL SWITCH	96	SCREW TAPPING 5*8
42	GEAR GOVERNOR	97	PROTECTOR MUFFLER
43	PIN GOVERNOR WEIGHT	98	MUFFLER ASSY
44	SHAFT GOVERNOR	99	NUT HEX 8MM
45	CLIP GOVERNOR HOLDER	100	GASKET MUFFLER
46	WEIGHT GOVERNOR	101	BOLT STUD EXHAUST
47	WASHER PAIN 6x15x0.5	102	SHROUD
48	SLIDER GOVERNOR	103	RING SET
49	CRANKSHAFT COMP	104	PISTON
50	PACKING CASE COVER	105	CLIP PISTON PIN
51	OIL FILLER CAP	106	PIN PISTON
52	PACKING OIL FILLER CAP	107	CONNECTING ROD
53	COVER	108	OIL STICK
54	BOLT FLANGE	201	RECOIL STARTER COMP
55	BOLT FLANGE	202	AIR CLEANER COMP.